

Ballscrews

Rolled Ballscrews

2.2.4.2 Cylindrical Single Nuts RSIT with Screw Thread

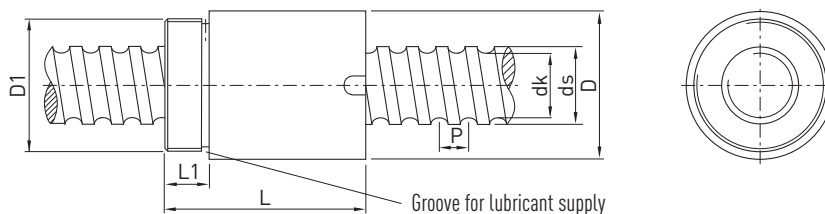

Table 2.5 Dimensions of the nut

| Article number | ds | P | D -0,2 | D1 | L -0,5 | L1 | dk | Dyn. Load C_{dyn} [N] | Stat. Load C_0 [N] | Axial play max. [mm] | Mass [kg/pc.] |
|-----------------|------|-----|-----------|---------|-----------|------|-----|----------------------------|-------------------------|----------------------|---------------|
| R08-02,5T2-RSIT | 7,7 | 2,5 | 17,5 | M15 × 1 | 27,5 | 7,5 | 6,1 | 1200 | 3360 | 0,04 | 0,04 |
| R10-02,5T2-RSIT | 9,3 | 2,5 | 19,5 | M17 × 1 | 25,0 | 7,5 | 8,1 | 1780 | 2630 | 0,04 | 0,06 |
| R10-04T2-RSIT | 9,7 | 4 | 24,0 | M22 × 1 | 32,0 | 10,0 | 7,7 | 1980 | 2820 | 0,04 | 0,08 |
| R12-04B1-RSIT | 11,9 | 4 | 25,5 | M20 × 1 | 34,0 | 10,0 | 9,5 | 3000 | 5700 | 0,04 | 0,1 |

R10-02,5T2-RSIT and R10-04T2-RSIT without wiper, R08-02,5T2-RSIT and R12-04B1-RSIT with single-sided polyamide wiper.

- Reduced axial play on request
- Nuts with wipers
- Precision ground ball grooves

Order example: **R** 12 **4** **B1** **RSIT** 350 **405** **0,052**

2.2.4.3 Cylindrical Single Nuts RSI

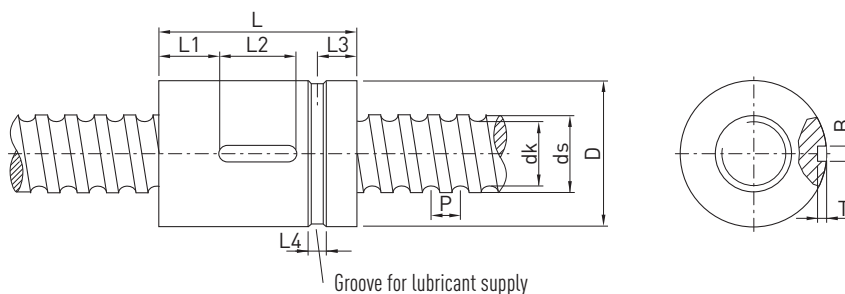

Table 2.6 Dimensions of the nut

| Article number | | P | D g7 | L ±0,2 | L1 | L2 | L3 | L4 | T +0,1 | B P9 | dk | Dyn. Load C_{dyn} [N] | Stat. Load C_0 [N] | Axial play max. [mm] | Mass [kg/pc.] |
|----------------|------|----|---------|-----------|----|----|------|----|-----------|---------|------|----------------------------|-------------------------|----------------------|---------------|
| R16-10T3-RSI | 15,3 | 10 | 28 | 60 | 8 | 20 | 9,5 | 5 | 2,5 | 4 | 12,9 | 6100 | 10800 | 0,04 | 0,19 |
| R20-10T3-RSI | 19,8 | 10 | 34 | 60 | 20 | 20 | 12,0 | 4 | 2,0 | 5 | 17,5 | 8100 | 12600 | 0,04 | 0,26 |

- Reduced axial play on request
- Nuts with wipers
- Precision ground ball grooves

Order example: **R** 16 **10** **T3** **RSI** 350 **405** **0,052**