

2.4.3 Housing for Flange Nuts (DIN 69051 Part 5)

The nut housing is suitable for installation of flange nuts DEB (page 98), DDB (page 99) and FSCDIN (page 95). The stage height of the housing is matched to the fixed bearing SFA (page 108) and the supported bearing SLA (page 110).

The housing unscrews from the top (S1) and bottom (S2) and is pinned using two taper pins or cylindrical pins. Two screws of property class 8.8 must be provided to secure the housing.

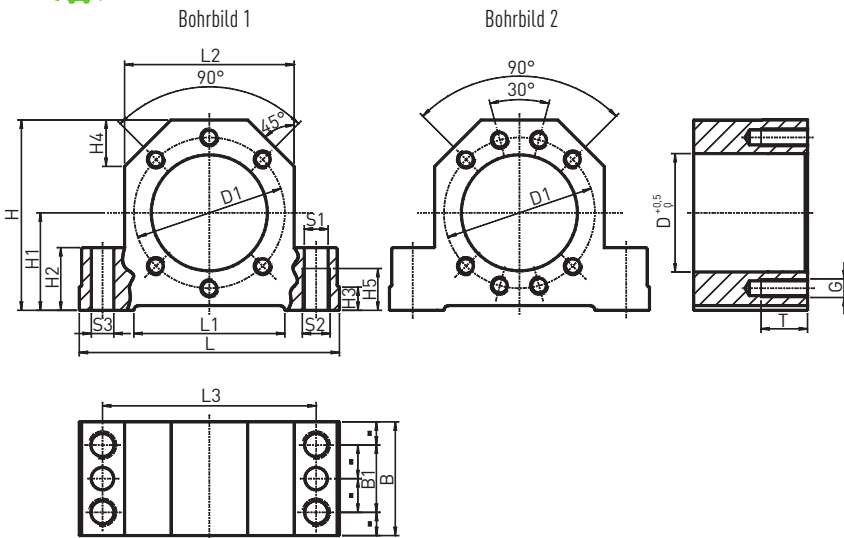

Table 2.30 Dimensions of the nut housing

Spindle Ø	Article number	L	L1	L2	L3	H	H1 JS7	H2	H3	H4	H5
16	GFD-16	86	52	52	68	58	32	22	7	15	15
20	GFD-20	94	52	60	77	64	34	22	7	17	15
25	GFD-25	108	65	66	88	72	39	27	10	19	18
32	GFD-32	112	65	72	92	82	42	27	10	19	18
40	GFD-40	126	82	84	105	97	50	32	13	23	21
50	GFD-50	146	82	104	125	115	60	32	13	30	21

Table 2.31 Dimensions of the nut housing

Spindle Ø	Article number	D	D1	B	B1	S1 H12	S2	S3	Drill template	G	T
16	GFD-16	28	38	37	23	8,4	M10	7,7	1	M5	12
20	GFD-20	36	47	42	25	8,4	M10	7,7	1	M6	15
25	GFD-25	40	51	46	29	10,5	M12	9,7	1	M6	15
32	GFD-32	50	65	49	29	10,5	M12	9,7	1	M8	20
40	GFD-40	63	78	53	32	12,6	M14	9,7	2	M8	20
50	GFD-50	75	93	59	34	12,6	M14	9,7	2	M10	25